



# TSUDAKOMA

## RNE Series

Superior Quality **ECONOMIC PRICING**



# DMG MORI

QUALIFIED PRODUCTS

DuraVertical 635 ECOLINE

DuraVertical 1035 ECOLINE



20 Thompson Rd | East Windsor | CT 06088  
1.800.249.5662 | 860.623.4132 Fax  
[www.komaprecision.com](http://www.komaprecision.com) | [info@komaprecision.com](mailto:info@komaprecision.com)

**DMG MORI**

QUALIFIED PRODUCTS



**DuraVertical 635 ECOLINE**



**DuraVertical 1035 ECOLINE**

		RNE-160R	RNE-200R	RNE-250R	RNE-320R
<b>TSUDAKOMA</b>	Table diameter (optional)   mm	(160, 200)	(200, 250)	250	320
	Maximum Table Speed   RPM	44.4	44.4	33.3	33.3
	Indexing Accuracy   Repeatability	±12   ±3.5	±10   ±3.5	±10   ±3.5	±15   ±3.5
	Clamp System	Pneumatic			
	Clamp torque @72psi Nm (ft. lbs.)	250 (180)	400 (295)	600 (442)	1,000 (737)
Machine	Travel Size X Y Z	RNE-160R	RNE-200R	RNE-250R	RNE-320R
DuraVertical 635 ECOLINE	25" x 20.1" x 18.1"	■	■	■	■
DuraVertical 1035 ECOLINE	40.7" x 22" x 20.1"	■	■	■	■

The RNE Series Rotary Table from Koma Precision, Inc. performs with high accuracy and fast indexing speed. Constructed with Tsudakoma’s patented dual lead gearing system guarantees wear resistance, rigidity and the rapid speeds of this rotary table.

Tsudakoma utilizes full tooth depth engagement along with a larger gear module. The results are a larger surface contact area yielding a substantially stronger worm gear system. The Tsudakoma worm wheel uses an oversize diameter pitch circle resulting in reduced pressure on the contact surface compared to a conventional gearing system. These properties, as well as ultra precision cross over roller bearings, all work to enhance system rigidity and longevity.



### TORQUE TRANSFER EFFICIENCY

The Tsudakoma dual lead gearing system features the largest tooth engagement of any rotary table manufacturer. **This system generates up to 85% torque transfer efficiency.** Tsudakoma’s dual lead gearing system features exceptionally smooth cutting due to the inherent lubricating properties of the gear materials.

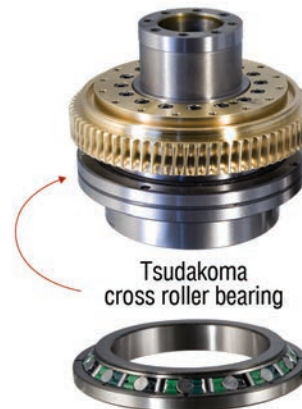

### CROSS ROLLER BEARINGS

Ultra precision cross roller bearings support radial, axial, and moment loads providing four times the level of stiffness as angular contact bearings. Cross roller bearings are constructed with a sequence of cylindrical rollers arranged at right angles to each other within a sealed 90° V-groove. All Tsudakoma rotary tables and indexers use ultra precision cross roller bearings.

# INTERFERENCE DRAWINGS FOR DURAVERTICAL ECOLINE SERIES

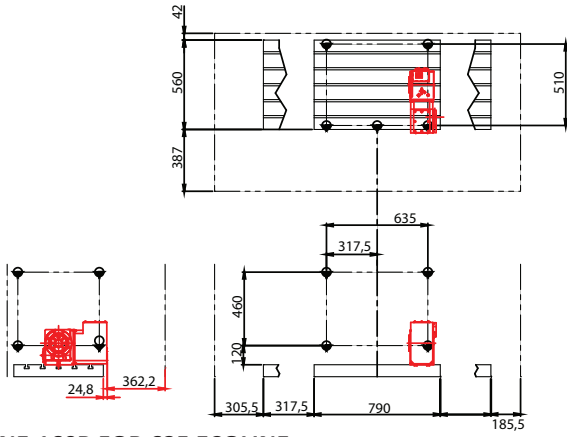

**RNE-160R FOR 635 ECOLINE**

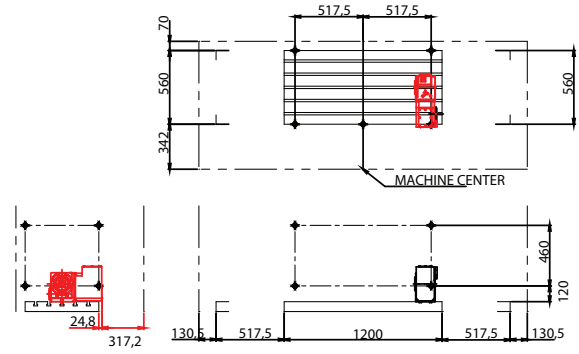

**RNE-160R FOR 1035 ECOLINE**

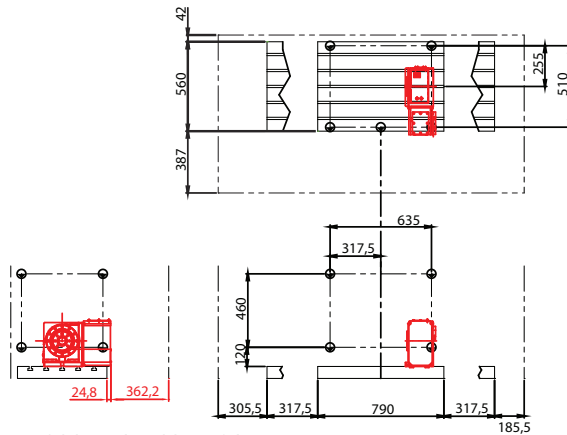

**RNE-200R FOR 635 ECOLINE**

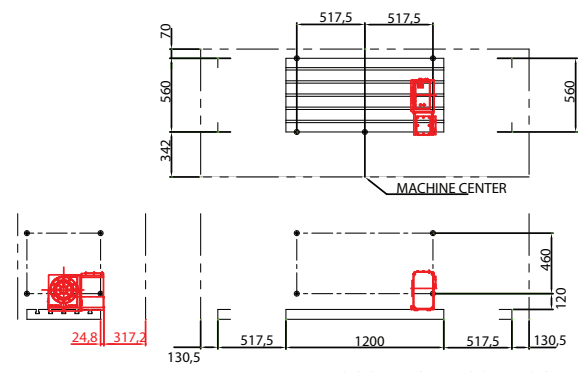

**RNE-200R FOR 1035 ECOLINE**

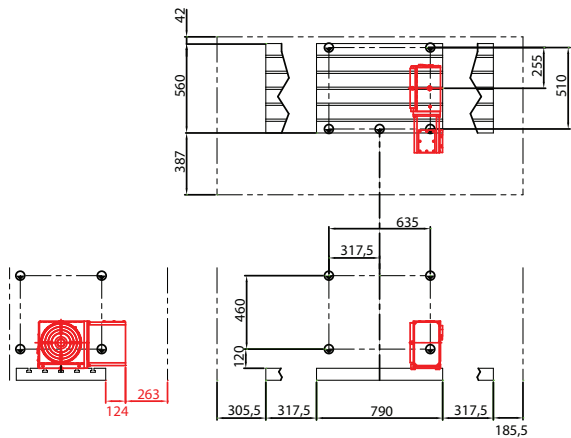

**RNE-250R FOR 635 ECOLINE**

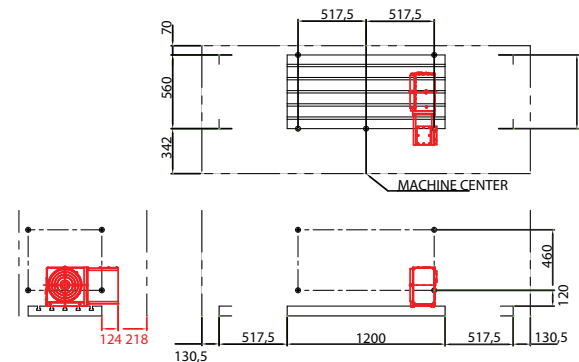

**RNE-250R FOR 1035 ECOLINE**

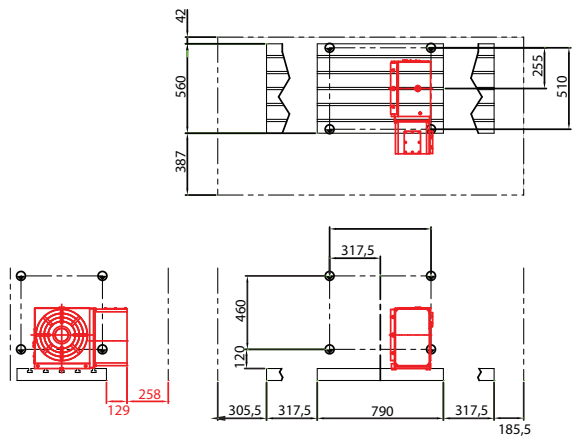

**RNE-320R FOR 635 ECOLINE**

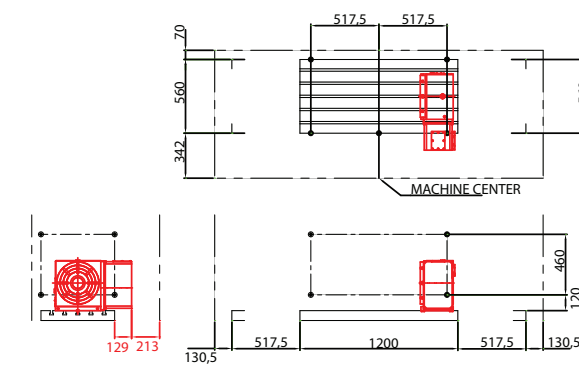

**RNE-320R FOR 1035 ECOLINE**

# TSUDAKOMA RNE Series 4 AXIS ROTARY TABLES

**Best value in its class**  
**Economical. Compact. High Accuracy.**

## Specifications

Table Model		RNE-160	RNE-200	RNE-250	RNE-320
Versions available		R	R	R	R
Spindle outer diameter		100h7	120h7	-	-
Table diameter (optional)		(160, 200)	(200, 250)	250	320
Center height		135	160	160	210
Center bore	Nose Diameter	55H7	65H7	75H7	110H7
	Thru Diameter	40	45	45	82
Table T-slot width (with faceplate)		(12H8)	(12H8)	(12H8)	14H8
Guide block width		18h7	18h7	18h7	18h7
Servo motor*		HF154T-A48	HF154T-A48	HF154T-A48	HF204S-A48
Maximum motor speed	rpm	4,000	4,000	4,000	4,000
Speed reduction ratio		1/90	1/90	1/120	1/120
Maximum table speed	rpm	44.4	44.4	33.3	33.3
Inertia converted into motor shaft	x 10 <sup>-3</sup> kg·m <sup>2</sup>	.09	.17	.41	.52
Clamp system		Pneumatic Disc Clamp	Pneumatic Disc Clamp	Pneumatic Disc Clamp	Pneumatic Disc Clamp
Clamp torque @72psi	Nm (ft. lbs.)	250 (180)	400 (295)	600 (442)	1,000 (737)
Indexing accuracy	arc sec.	±12.5	±10	±10	±10
Repeatability	arc sec.	±3.5	±3.5	±3.5	±3.5
Net Weight	kg (lbs.)	44 (97)	62 (136)	107 (235)	205 (451)
Allowable wheel torque	Nm (ft. lbs.)	206 (152)	288 (212)	565 (416)	939 (692)
Allowable work inertia	kg·m <sup>2</sup>	.48	1.25	1.95	3.77
Allowable work weight [with tailstock]	kg (lbs)	75 (165) [150 (330)]	100 (220) [250 (550)]	100 (220) [250 (550)]	150 (330) [350 (770)]
Allowable load when table clamped	Nm (ft. lbs.)	7,840 (1,762)	13,720 (3,085)	13,720 (3,073)	19,600 (5,555)
	Nm (ft. lbs.)	392 (290)	980 (723)	980 (723)	1960 (1445)

## Options & Accessories

Additional Accessories Available



T-Slotted Faceplates



3-Jaw Scroll Chucks



Manual Tailstock w/ MT2 Center



Support Spindle



Support Spindle w/ Pneumatic Clamp



Pneumatic 5C Collet Chuck

Dimensions = mm  
 Specifications subject to change without notice

## Rotary Table Dimensions

Reference Only • Detailed drawings available upon request

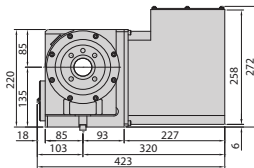

RNE-160

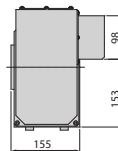

RNE-200

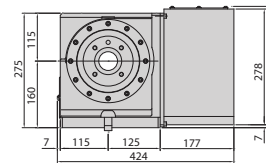

RNE-250

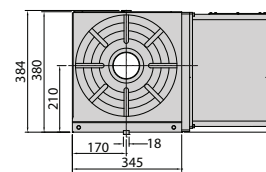
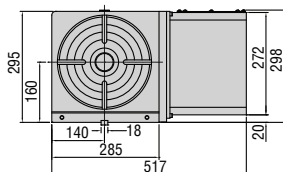

RNE-320