



TURBOFLEX ANGLE HEADS



**MAKINO
MAG 1**



20 Thompson Rd | East Windsor | CT 06088
1.800.249.5662 | 860.623.4132 Fax
www.komaprecision.com | info@komaprecision.com

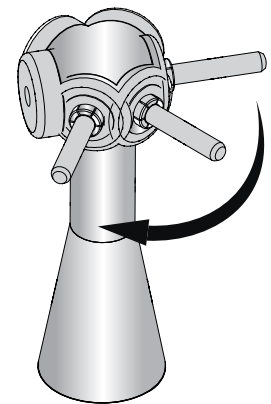
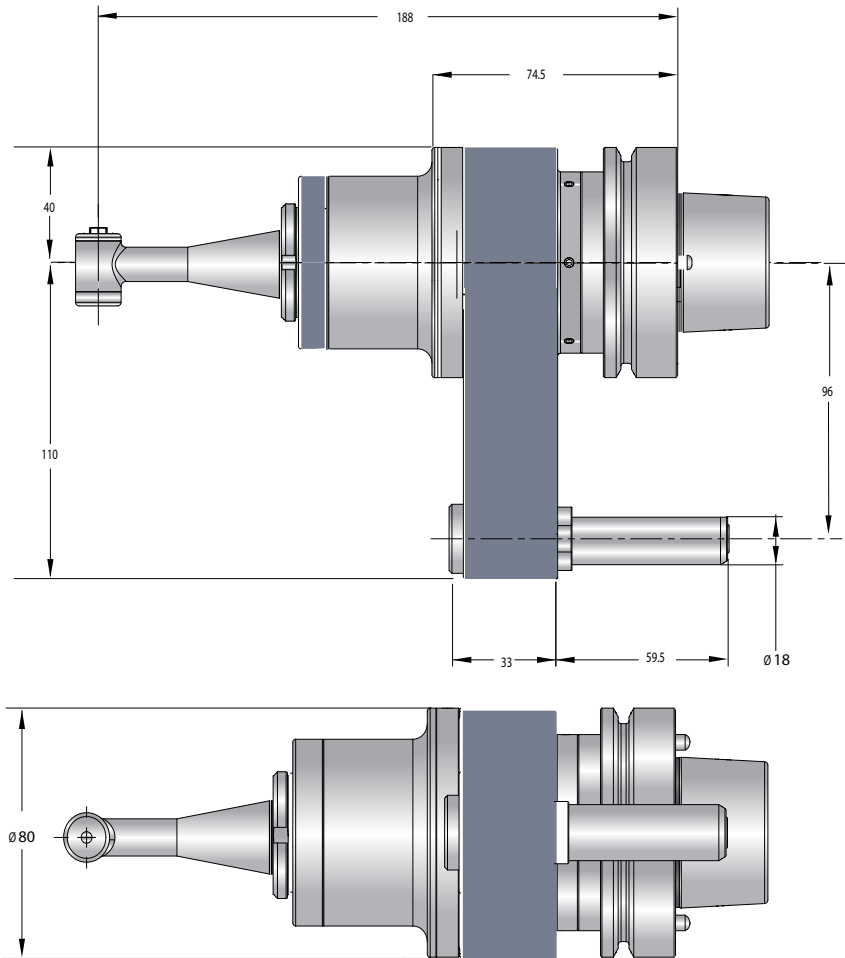

MAG1 Optional Programmable Spindle allows 360 degree positioning of the NSK output.

Technical Data

TF-IC-300

Tool RPM Maximum	30,000	Reduction Ratio	.75/1
NSK Output RPM	20,000	Air Pressure	90 psi max.
Air Motor	AM-310	Air Consumption	7.98 cfm
NSK Output Tool	IC-300	Weight	8.8 lbs
Power	0.14 HP	Collet	CHC

Included with Tool: Storage Case • Wrenches • Grease • Instruction Manual

Torque Speed

Torque-Speed Chart AM-310

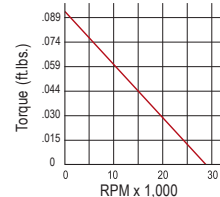

Coolant Option

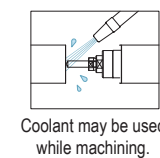

Spindle Runout

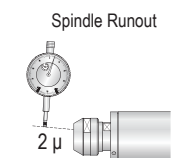

COLLETS	
CHC (TF-IC-300)	
	
Model	Inside Diameter (mm)
GP-59021-00	1.6
GP-59024-00	2.35
GP-59015-00	3.0
GP-59010-00	3.175

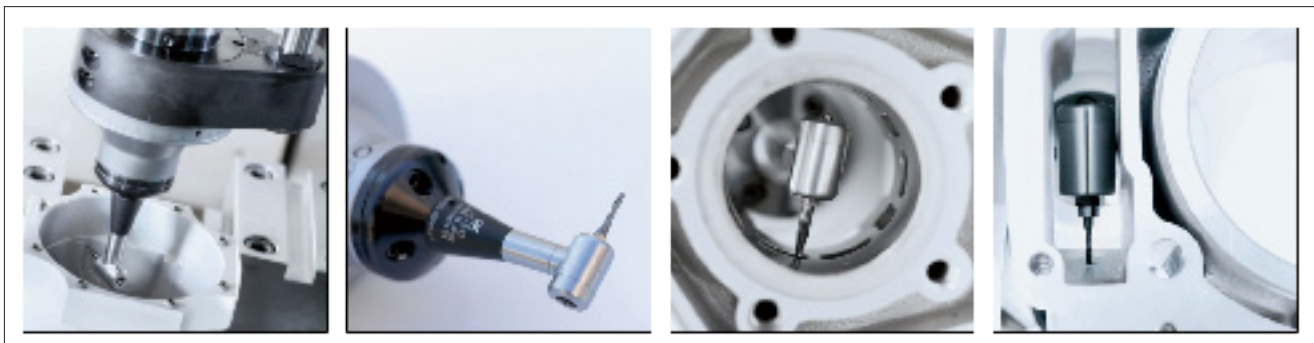



20 Thompson Rd | East Windsor | CT 06088
1.800.249.5662 | 860.623.4132 Fax
www.komaprecision.com | info@komaprecision.com

ROTARY TABLES | ANGLE HEADS | LIVE TOOLS | SWISS TOOLS | TOOL PRESETTERS